

# Fosfato total 45

**Test 0-55**

REF 985 055



Teste em tubo

690 nm

Método

5.0–50.0 mg/L P  
15–150 mg/L  $\text{PO}_4^{3-}$   
10–115 mg/L  $\text{P}_2\text{O}_5$

0551

0552

0553

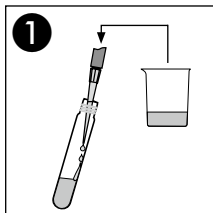

200 µL Amostra

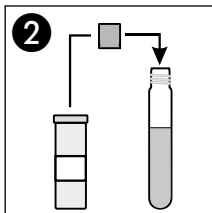

1 x *NANOFIX R2*

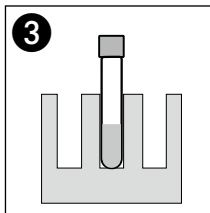

120 °C/30 min  
ou  
100 °C/ 1 h

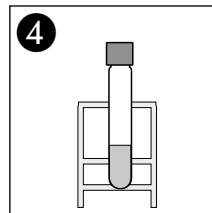

Deixe esfriar

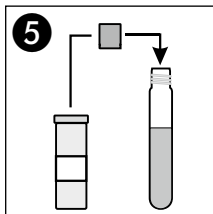

1 x *NANOFIX R3*

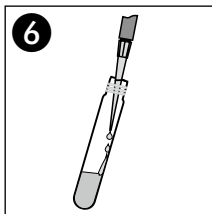

200 µL R4

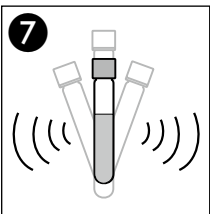

Agitar

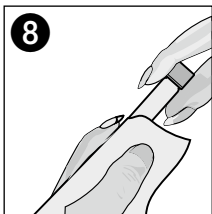

Limpar

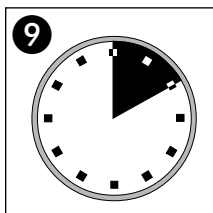

10'00 min

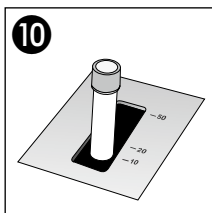

Medir

# Orto fosfato 45

**Test 0-55**

REF 985 055



## Teste em tubo

5.0–50.0 mg/L  $\text{PO}_4\text{-P}$

15–150 mg/L  $\text{PO}_4^{3-}$

10–115 mg/L  $\text{P}_2\text{O}_5$

690 nm

Método

0554

0555

0556

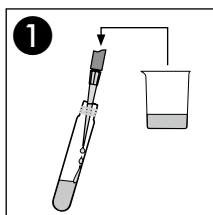

**1**  
200  $\mu\text{L}$  Amostra

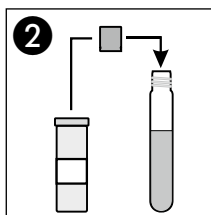

**2**  
1 x **NANOFIX R3**

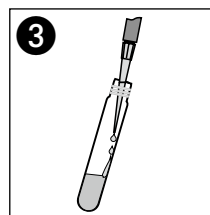

**3**  
200  $\mu\text{L}$  R4

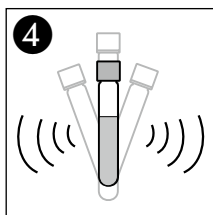

**4**  
Agitar

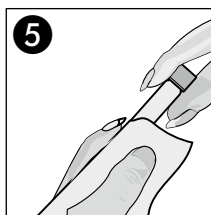

**5**  
Limpar

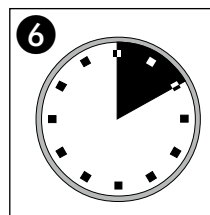

**6**  
10'00 min

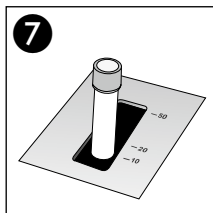

**7**  
Medir